

**ALUMINOX**  
Comercial **BJ** desde 1975



TUBO DECORACION

TUBO CUADRADO  
TUBO RECTANGULAR

# ALUMINOX

Comercial **BJ** desde 1975

## TUBO RECTANGULAR

Peso teórico (kg/m)

Soldadura : HF (TIG mediante pedido)

Calidad: AISI 304 - 316

Largo estandar: 6 metros

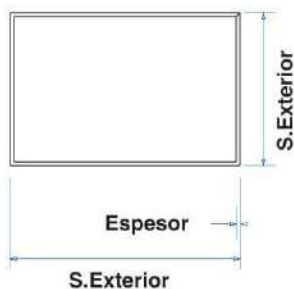
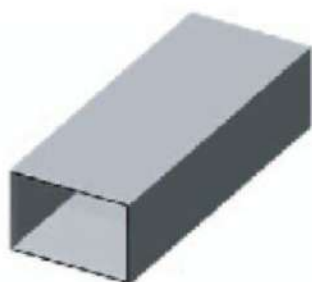

Sección mm	Espesor en mm							
	1,0	1,2	1,5	2,0	2,5	3,0	4,0	5,0
20x10	0,453	0,538	0,661					
30x15	0,693	0,825	1,020	1,335				
30x20	0,772	0,921	1,140	1,494				
40x20	0,926	1,112	1,379	1,813				
50x20	1,091	1,303	1,618	2,132				
50x25		1,399	1,738	2,292				
50x30	1,251	1,495	1,857	2,451				
60x20		1,495	1,857	2,451				
60x40		1,878	2,336	3,089	3,819	4,559	5,960	
80x40		2,261	2,814	3,727	4,600	5,491	7,222	
100x40			3,293	4,365	5,408	6,531	8,450	
100x50			3,532	4,684	5,790	6,950	9,090	
120x60				5,642		8,388	11,049	13,728

## TUBO CUADRADO

Peso teórico (kg/m)

Soldadura : HF (TIG mediante pedido)

Calidad: AISI 304 - 316

Largo estandar: 6 metros

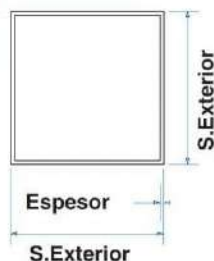
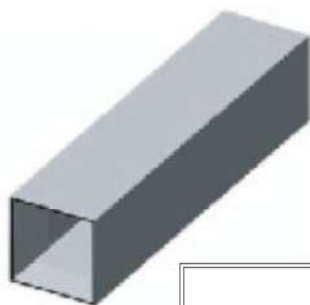

Sección mm	Espesor en mm							
	1,0	1,2	1,5	2,0	2,5	3,0	4,0	5,0
10x10	0,294							
12x12	0,358							
15x15	0,453	0,538	0,661					
16x16	0,485	0,576	0,709	0,920				
18x18	0,549	0,653	0,805					
20x20	0,613	0,729	0,900	1,175				
25x25	0,772	0,921	1,140	1,494	1,846	2,179		
30x30	0,932	1,112	1,379	1,813	2,222	2,645		
35x35	1,090	1,303	1,618	2,132	2,629	3,118		
40x40	1,250	1,495	1,857	2,451	3,036	3,602	4,708	
50x50	1,570	1,878	2,336	3,089	3,818	4,559	5,960	
60x60			2,814	3,727	4,607	5,516	7,220	
80x80			3,771	5,003	6,203	7,430	9,807	12,095
100x100			4,728	6,279	7,918	9,343	12,358	15,322
120x120				7,555		11,257	14,910	18,512
150x150				9,469		14,129	18,738	23,297